



# INSTRUCTION BULLETIN

No. 9010968  
Machine: T12  
Published: 05-2013  
Rev. 00

**NOTE: DO NOT DISCARD the Parts List from the Instruction Bulletin. Place the Parts List in the appropriate place in the machine manual for future reference. Retaining the Parts List will make it easier to reorder individual parts and will save the cost of ordering an entire kit.**

*NOTE: Numbers in parenthesis ( ) are reference numbers for parts listed in Bill of Materials.*

Installation instructions for **kit number 9010938**

## SYNOPSIS:

This kit contains the parts needed to replace the side brush spring assembly on T12 scrubbers. Please follow step-by-step instructions.

## SPECIAL TOOLS / CONSIDERATIONS: NONE

(Estimated time to complete: 1 hour)



### PROTECT THE ENVIRONMENT

Please dispose of packaging materials, old machine components, and hazardous fluids in an environmentally safe manner according to local waste disposal regulations.

Always remember to recycle.

## PREPARATION:

1. Park the machine on a clean level surface, completely lower the side brush out into the scrub position, turn off the machine, and remove the key.

**FOR SAFETY: Before leaving or servicing machine, stop on level surface, turn off machine, and remove key.**

## INSTALLATION:

1. Remove the existing spring assembly from the side brush assembly. Discard the spring assembly and all mounting hardware (hex nuts, flat washers, and rod ends). (Fig. 1)
2. Thread the M10 jam nuts (7) onto the spring assembly (1). (Fig. 1)
3. Thread the rod ends (6) onto the spring assembly (1). (Fig. 1)
4. Use two M10 hex nuts (8) and two flat washers (9) to install the spring assembly (1) onto the machine. Adjust the rod ends (6) as necessary to correctly position the spring assembly in the side brush assembly. (Fig. 1)
5. Tighten the M10 jam nuts (7) against the rod ends (6). (Fig. 1)
6. Start and test the machine. Watch side brush move through range of motion when system is turned on and again when it is turned off. The side brush should move through the complete range of motion.

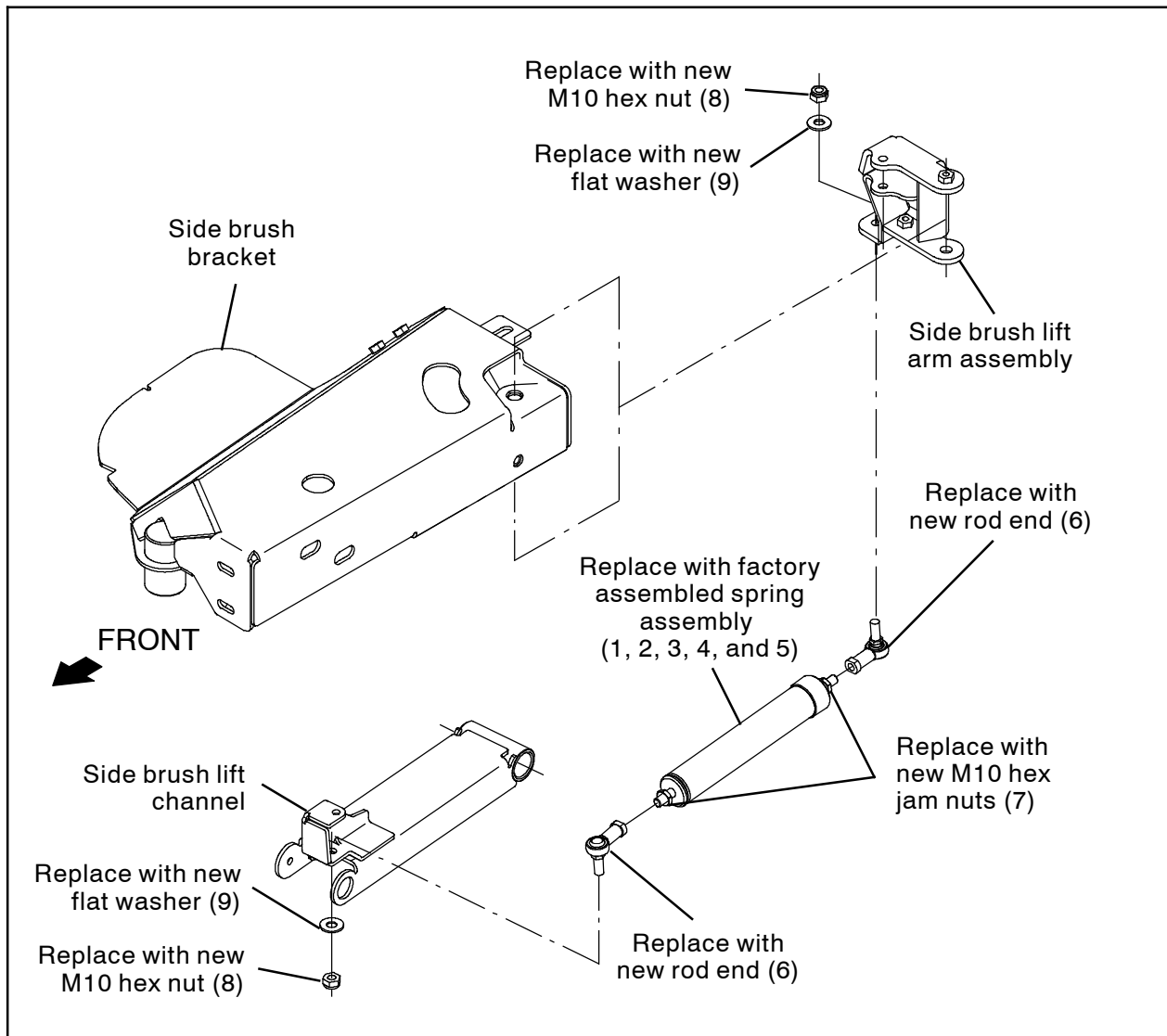

FIG. 1

Bill Of Materials For Spring Assy, Replmt, Afmkt [T12] - 9010938

Ref.	Tennant Part No.	Description	Qty.
▽	9010938	Spring Assy, Replmt, Afmkt [T12]	1
▲	1 1200855	Rod, Thrd, M10	1
▲	2 1200861	Support, Spring	1
▲	3 1200863	Retainer, Spring	1
▲	4 1201261	Spring, Cmpr	1
▲	5 1201284	Tube Wldt, Spring	1
▲	6 05686	Rod- End, M10 X 1.5RH Fem M10 X 1.5Stud	2
▲	7 763064	Nut, Hex, Jam, M10 X 1.5, [DIN439]	3
▲	8 08714	Nut, Hex, Lock, M10 X 1.5, NL, SS	2
▲	9 01686	Washer, Flat, 0.44B 1.00D .08, SS	2

TENNANT COMPANY  
P. O. Box 1452  
Minneapolis, MN 55440-1452